

REFLECTED SOFFIT SHEETING LAYOUT

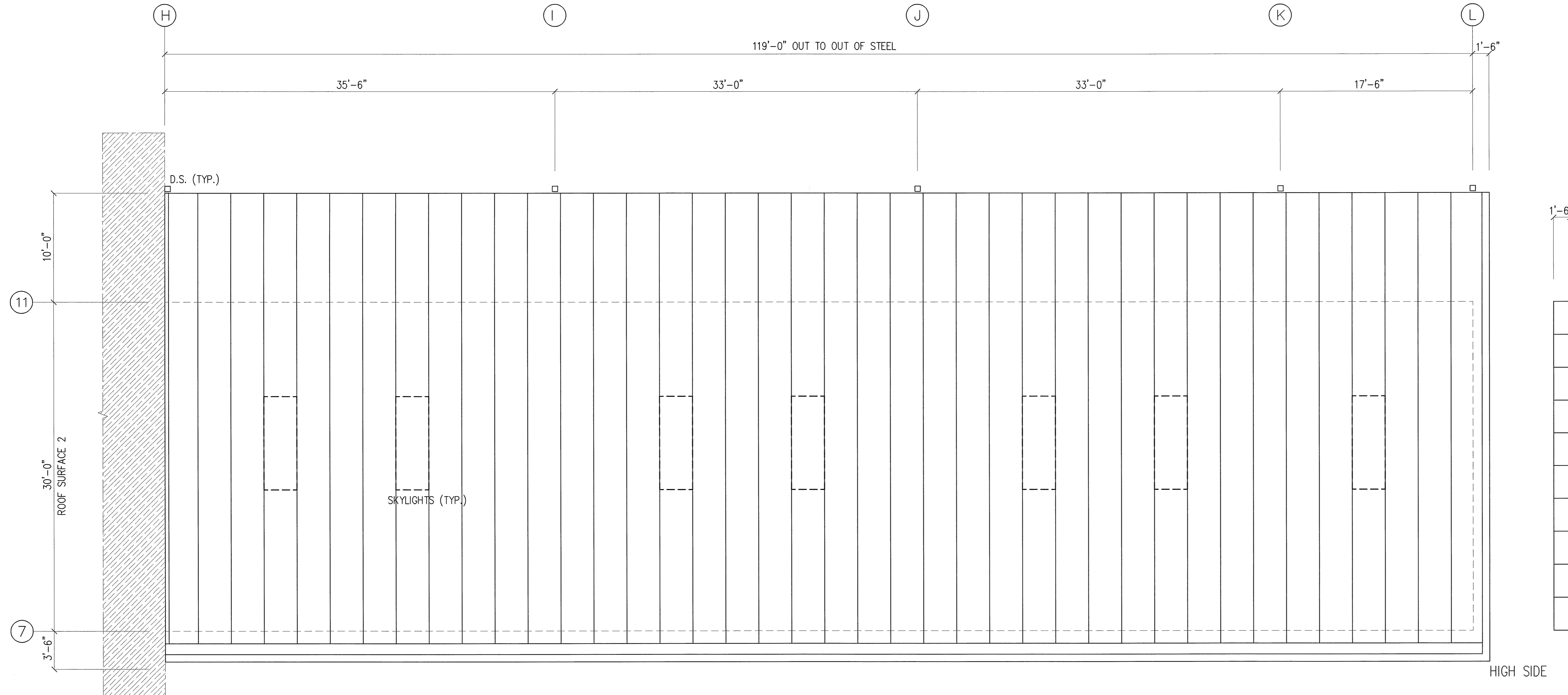

ROOF SHEETING LAYOUT

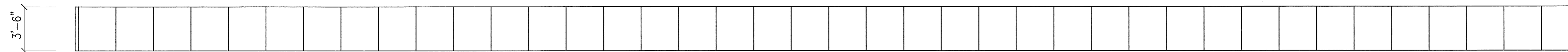

REFLECTED SOFFIT SHEETING LAYOUT

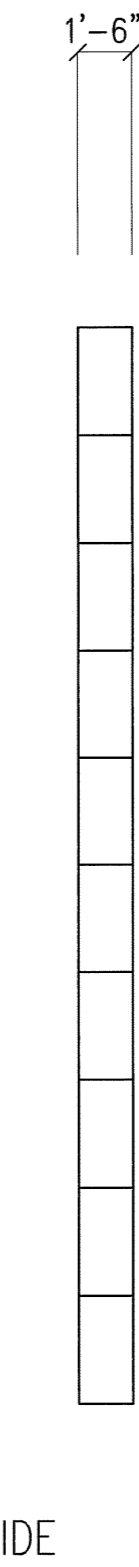

REFLECTED SOFFIT SHEETING LAYOUT

- GENERAL NOTES:**
- OIL CANNING OF PANELS IS NOT A CAUSE OF REJECTION.
  - EXTREME CARE MUST BE EXERCISED DURING ERECTION OF ROOF PANELS AND TRIMS. FOOT TRAFFIC MAY RESULT IN PERMANENT PANEL DISTORTION AND FINISH ABRASION.
- IMPORTANT ERECTOR'S NOTES:**
- MEMBER SCREWS AND STITCH SCREW PATTERNS AND LOCATIONS SHALL BE IN ACCORDANCE WITH ROOF AND WALL DETAILS SHOWN ON SHT. - E
  - RBSI SUPPLIES 5% FOR OVERAGE AND ANY CLAIM ON SHORTAGE BECAUSE OF NON COMPLIANCE WITH THE DRAWINGS SHALL NOT BE RBSI'S RESPONSIBILITY.
  - IN THE EVENT THAT A DISCREPANCY OR ERROR ARISES WITH MATERIALS SHIPPED FOR THIS PROJECT ON THESE ERECTION DRAWINGS, THE ERECTOR / INSTALLER MUST NOTIFY R.B.S.I. PRIOR TO CORRECTING. IF R.B.S.I. IS NOT NOTIFIED, R.B.S.I. WILL NOT HONOR BACKCHARGES BY ANY PARTY INVOLVED.
  - FAILURE TO INSTALL THE ROOF SHEETS IN ACCORDANCE WITH THE SHEETING DIRECTIONAL ARROWS SHOWN ON THESE PLANS MAY RESULT IN IMPROPER FIT-UP OF THE OUTSIDE CLOSURES (END DAMS) AND POSSIBLY OTHER TRIM COMPONENTS WHICH COULD AFFECT THE OVERALL APPEARANCE AND WEATHER TIGHTNESS OF THE BUILDING. RIGID WILL NOT BE HELD RESPONSIBLE THE CHARGES OR ADDITIONAL FIELD WORK REQUIRED DUE TO NOT FOLLOWING SHEETING DIRECTIONAL ARROWS AND OTHER PROCEDURES OUTLINED IN THE ERECTION MANUAL.

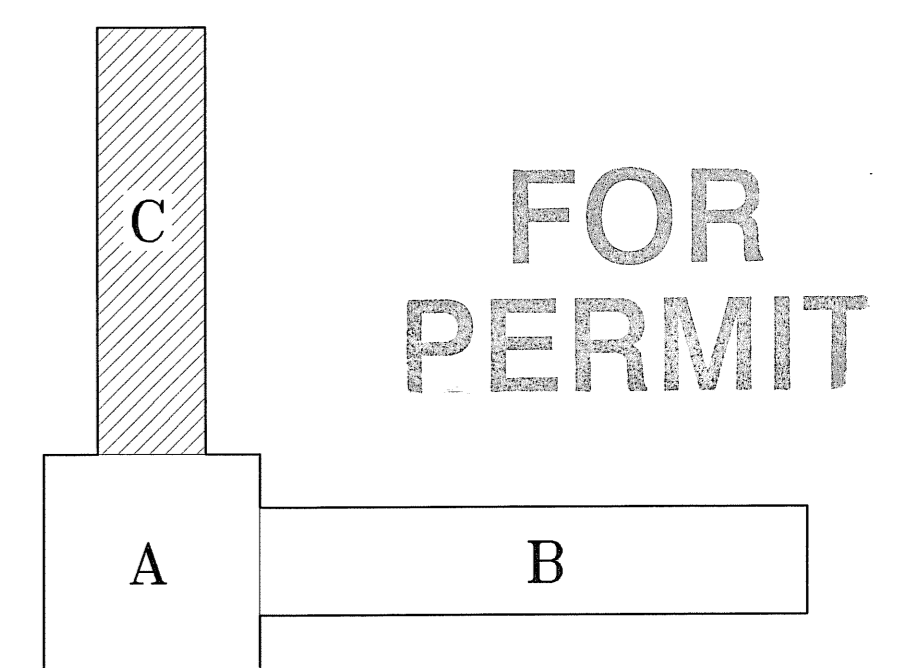

**FOR PERMIT**

KEY PLAN  
NORTH JUN 1 0 2008

SEALING OF THIS DRAWING DOES NOT IMPLY OR CONSTITUTE THAT RIGID BUILDINGS ENGINEER IS THE ENGINEER OF RECORD OR THE DESIGN PROFESSIONAL FOR THIS PROJECT. ONLY THE DESIGN OF THE METAL BUILDING SYSTEM AS FURNISHED BY RIGID IS INCLUDED. FOUNDATION ANALYSIS, ELECTRICAL, AND MECHANICAL SYSTEMS, AND/OR OTHER PARTS SUPPLIED BY ANYONE OTHER THAN RIGID ARE SPECIFICALLY EXCLUDED. NO INSPECTION OR SUPERVISION IS IMPLIED.

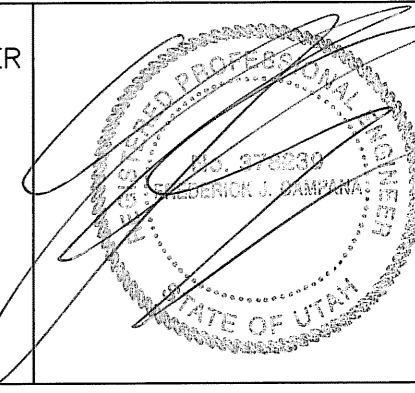

ISSUE	REV. DESCRIPTION	DATE	DRN. DES.
A	CONFIRMATION	05.20.08	FFF LDD

**RIGID BUILDING SYSTEMS**  
18933 Aldine Westfield  
Houston, Tx. 77073  
Phone : (281) 443-9065  
Fax : (281) 443-9064

DESCRIPTION	<b>ROOF SHEETING LAYOUT</b>		
CUSTOMER	ELEGANTE ENTERPRISES, INC.		
END USER	PAINTERS SERVICE CENTER		
END USE	OFFICE/SERVICE BAYS		
LOCATION	1600 HILTON DR. ST. GEORGE, UT 84770		
DRN. BY:	FFF	DATE:	05/20/08
JOB NO.:	28268-C	SCALE:	N.T.S.
CHK. BY:		DWG. NO.:	E2 OF
DATE:		ISSUE:	A