

MEZZANINE FLOOR FRAMING PLAN

NOTES:

1. JOISTS SHALL BE FIELD WELDED TO BEAMS OR SEAT PLATES UNLESS NOTED AS BOLTED. FOR BOLTED JOISTS, USE 1/2" $\frac{3}{8}$ 1-1/4" A-307 BOLT.
2. ALL BRIDGING AND BRIDGING ANCHORS SHALL BE COMPLETELY INSTALLED BEFORE CONSTRUCTION LOADS ARE PLACED ON THE JOISTS. THE ENDS OF ALL BRIDGING LINES TERMINATING AT WALLS OR BEAMS SHALL BE ANCHORED THERETO. HORIZONTAL OR DIAGONAL BRIDGING SHALL BE ATTACHED TO JOISTS BY MEANS OF WELDING OR MECHANICAL MEANS.
3. EDGE ANGLES SHALL BE TACK WELDED TO BEAMS OR JOISTS.
4. MEZZANINE DECK SHALL BE FASTENED WITH #12-24 $\frac{3}{8}$ 1-1/4" HEX WASHER HEAD (TOP5 ULTRA-Z POINT) SCREWS @ 12" O.C.
5. RIGID BUILDING SYSTEMS IS NOT RESPONSIBLE FOR THE DESIGN OF MEZZANINE CONCRETE SLAB AND ITS REINFORCEMENTS. ONLY MEZZANINE COMPONENTS CALLED OUT IN THE CONTRACT WILL BE SUPPLIED BY RIGID.

STAIR / RAILING DESIGN CRITERIA:

- * REFERENCE TABLE 16A : (5. EXIT FACILITIES) *
 - STAIRWAYS : TO BE DESIGNED WITH A UNIFORM LOAD OF 100 LBS./SQ.FT.
 - STAIR TREADS : ARE DESIGNED TO SUPPORT A 300 LB. CONCENTRATED LOAD PLACED IN POSITION FOR MAXIMUM STRESS.
 - STAIR STRINGERS : ARE DESIGNED WITH A UNIFORM LOAD OF 100 LBS./SQ.FT.
- * REFERENCE TABLE 16B : (9. BALCONY RAILINGS / GUARDRAILS) *
 - GUARDRAILS : ARE DESIGNED WITH LATERAL LOAD OF 50 LBS./LF. (APPLIED HORIZONTAL AT RIGHT ANGLES TO TOP RAIL).
- * REFERENCE TABLE 16B : (11. HANDRAILS - FOOTNOTE#11) *
 - HANDRAILS : THE MOUNTING OF THE HANDRAILS SHALL SUCH THAT THE COMPLETED HANDRAIL AND SUPPORTING STRUCTURE ARE CAPABLE OF WITHSTANDING A LOAD OF 200 LBS. APPLIED IN ANY DIRECTION AT ANY POINT ON THE RAIL.

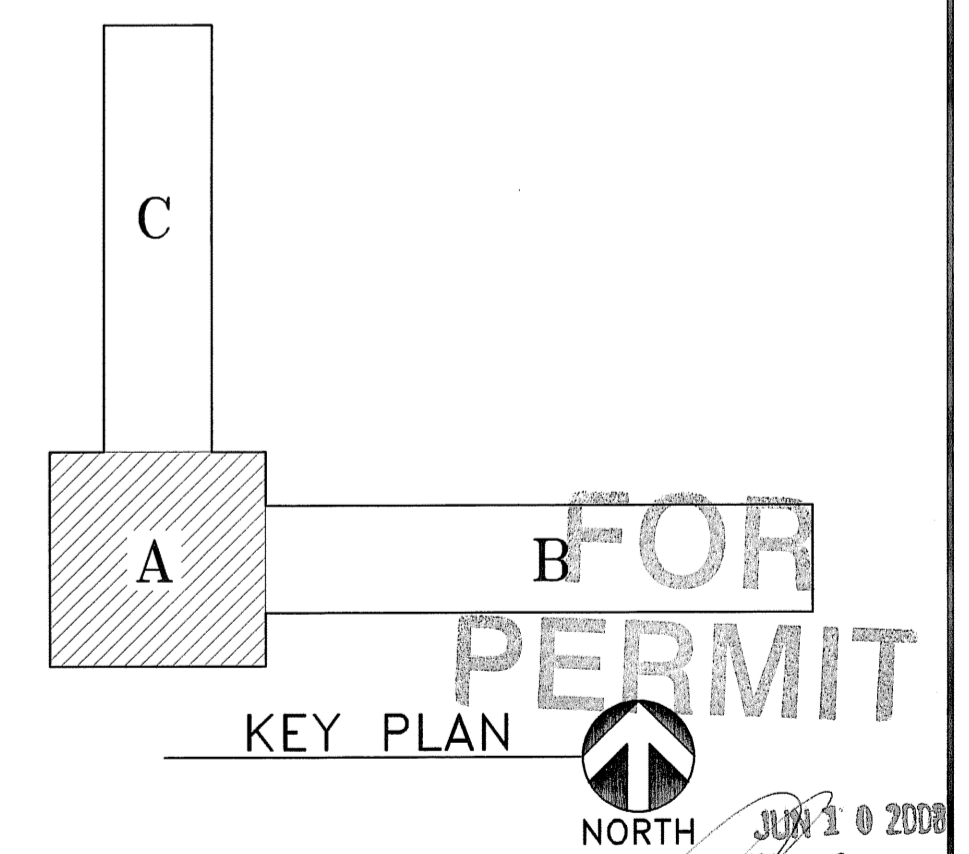

SEALING OF THIS DRAWING DOES NOT IMPLY OR CONSTITUTE THAT RIGID BUILDINGS ENGINEER IS THE ENGINEER OF RECORD OR THE DESIGN PROFESSIONAL FOR THIS PROJECT. ONLY THE DESIGN OF THE METAL BUILDING SYSTEM AS FURNISHED BY RIGID IS INCLUDED. FOUNDATION ANALYSIS, ELECTRICAL, AND MECHANICAL SYSTEMS, AND/OR OTHER PARTS SUPPLIED BY ANYONE OTHER THAN RIGID ARE SPECIFICALLY EXCLUDED. NO INSPECTION OR SUPERVISION IS IMPLIED.

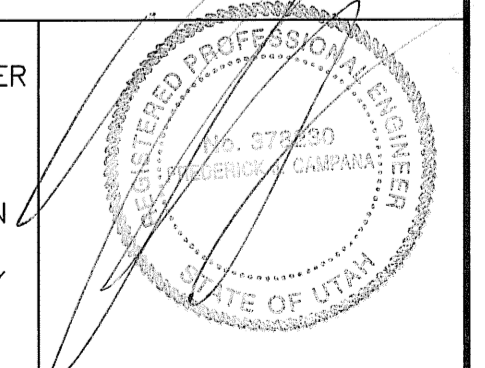

ISSUE	REV.	DESCRIPTION	DATE	DRN. DES.
A		CONFIRMATION	05.20.08	FFF LDD

RIGID BUILDING SYSTEMS
 18933 Aldine Westfield
 Houston, Tx. 77073
 Phone : (281) 443-9065
 Fax : (281) 443-9064

DESCRIPTION	MEZZANINE FLOOR FRAMING PLAN		
CUSTOMER	ELEGANTE ENTERPRISES, INC.		
END USER	PAINTERS SERVICE CENTER		
END USE	OFFICE/SERVICE BAYS		
LOCATION	1600 HILTON DR. ST. GEORGE, UT 84770		
DRN. BY:	FFF	DATE:	05/20/08
CHK. BY:		SCALE:	3/16"
DWG. NO.:	28268-A	ISSUE:	E9 OF A